

lavanto<sup>®</sup> sink:

# Sinks made of Solid Surface Material.

Iseo.

Caldo.

Vico.

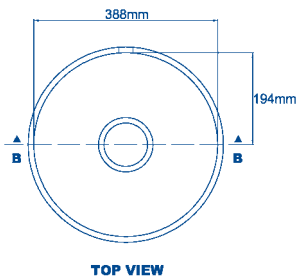

TOP VIEW

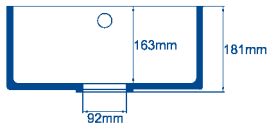

Section B - B

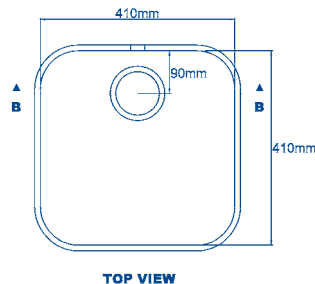

TOP VIEW

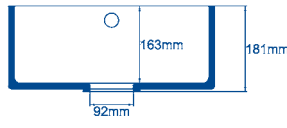

Section B - B

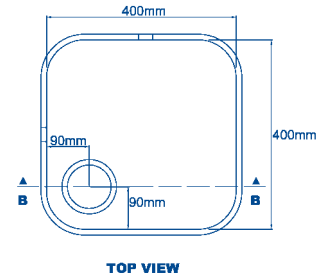

TOP VIEW

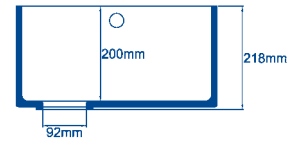

Section B - B

HI-MACS<sup>®</sup> 388C-H

HI-MACS<sup>®</sup> 410C-H

HI-MACS<sup>®</sup> 400C-H

Sinks available under the trademark **lavanto<sup>®</sup>** sink are manufactured from high-quality solid surface material.

Several model ranges can be ideally combined with a kitchen waste disposal basin.

Every sink is produced on commission, therefore you can choose from a vast range of colours. In addition, details such as the location of the overflow drain outlet can be individually selected. Due to groove-free fabrication and slightly rounded inside corners, the sinks can be cleaned quickly and easily. Some colours cannot be thermoformed as successfully as others. If you would like a colour or material for your sink not listed in this brochure, please contact your sales representative.

## Orta.

## Fondi.

## Garda.

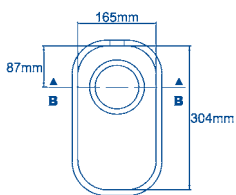

TOP VIEW

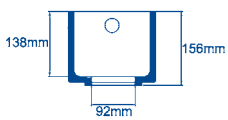

Section B - B

HI-MACS® 304C-H

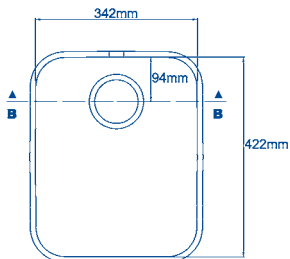

TOP VIEW

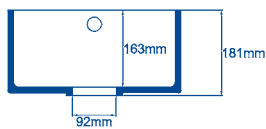

Section B - B

HI-MACS® 422C-H

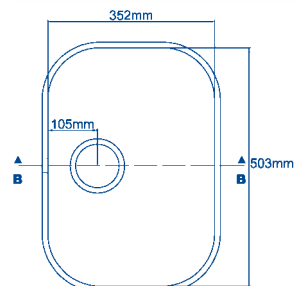

TOP VIEW

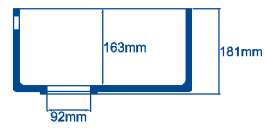

Section B - B

HI-MACS® 503C-H

lavanto<sup>®</sup> sink:

## Sinks made of Solid Surface Material.

---

### Muta 320-440.

### Muta 400-400.

---

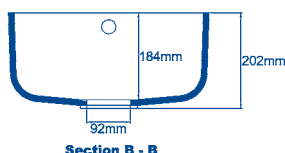
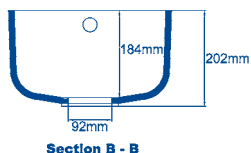
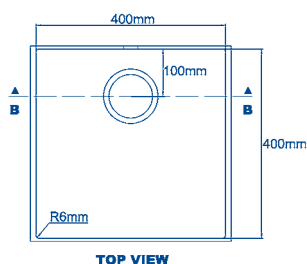
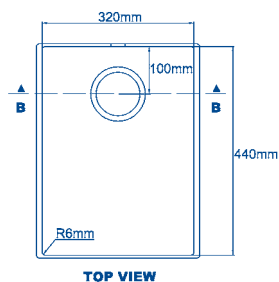

---

HI-MACS<sup>®</sup> 320-440C-H

HI-MACS<sup>®</sup> 400-400C-H

---

This sink is available only in a limited colour range!

This sink is available only in a limited colour range!

#### Possible combinations



Muta 320-440.  
Piani 170-310.



Muta 320-440.  
Piani 170-440.



Piani 170-310.  
Muta 400-400.  
Piani 170-310.

## Piani 170-310.

## Piani 170-400.

## Piani 170-440.

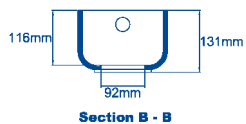
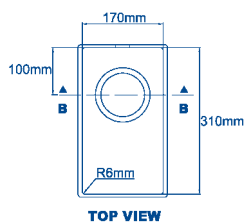

HI-MACS® 170-310C-H

This sink is available only in a limited colour range!

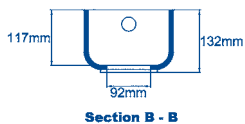
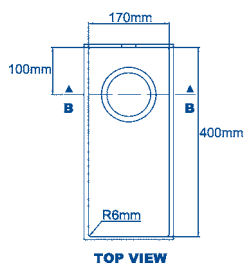

HI-MACS® 170-400C-H

This sink is available only in a limited colour range!

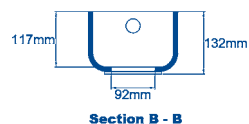
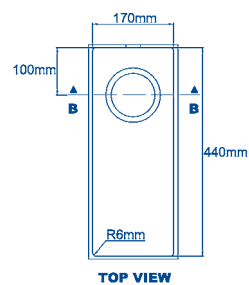

HI-MACS® 170-440C-H

This sink is available only in a limited colour range!



K+P



**lavanto**<sup>®</sup>  
s i n k

lavanto<sup>®</sup> sink:

# Sinks made of Solid Surface Material.

## Arie 330-330.

## Arie 500-330.

## Neves 165-250.

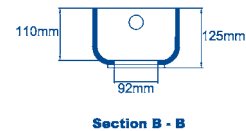
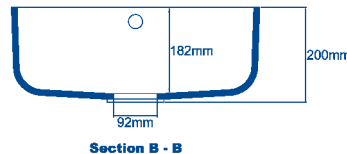
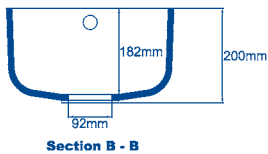
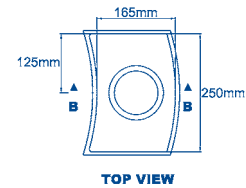
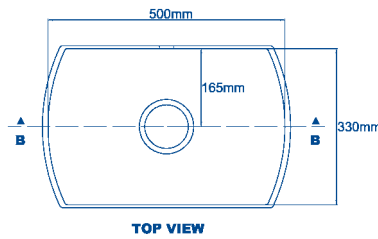
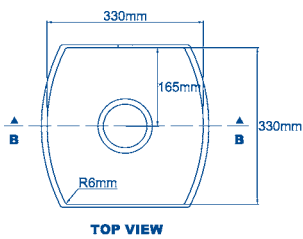

HI-MACS<sup>®</sup> 330-330C-H

HI-MACS<sup>®</sup> 500-330C-H

HI-MACS<sup>®</sup> 165-250C-H

This sink is available only in a limited colour range!

This sink is available only in a limited colour range!

This sink is available only in a limited colour range!

Please indicate whether this sink is to be installed with fittings on the left or right side.

### Possible combinations



Arie 330-330.  
Neves 165-250.



Neves 165-250.  
Arie 330-330.  
Neves 165-250.



Neves 165-250.  
Arie 330-330.

## Idro 200-400.

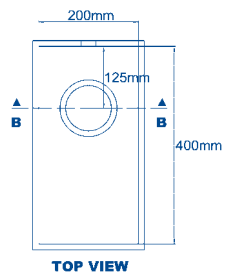

TOP VIEW

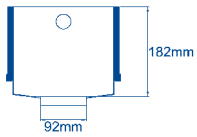

Section B - B

HI-MACS® 200-400I-H

Sink with stainless steel bottom!

## Idro 400-400.

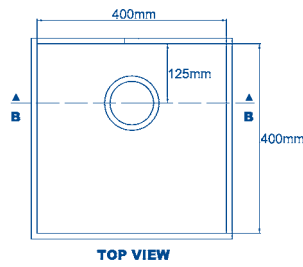

TOP VIEW

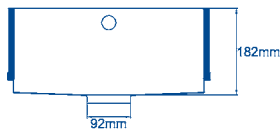

Section B - B

HI-MACS® 400-400I-H

Sink with stainless steel bottom!

## Idro 500-400.

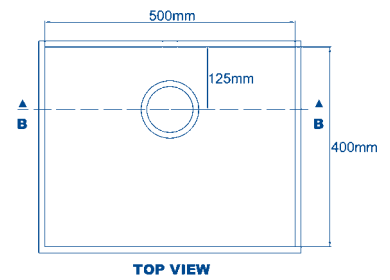

TOP VIEW

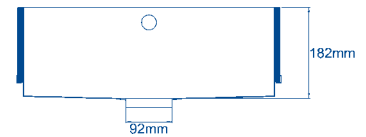

Section B - B

HI-MACS® 500-400I-H

Sink with stainless steel bottom!

lavanto<sup>®</sup> sink:

## Sinks made of Stainless Steel.

---

### Dénorm 001.



STAINLESS STEEL DE001

Dimensions: Ø 439 mm  
Depth of sink: 168 mm  
Minimum width  
of floor cupboard: 450 mm

### Dénorm 041.



STAINLESS STEEL DE041

Dimensions: Ø 439 mm  
Depth of sink: 168 mm  
Minimum width  
of floor cupboard: 450 mm

### Dénorm 003.



STAINLESS STEEL DE003

Dimensions: 438 x 378 mm  
Depth of sink: 162 mm  
Minimum width  
of floor cupboard: 450 mm

---

### Dénorm 043.



STAINLESS STEEL DE043

Dimensions: 438 x 378 mm  
Depth of sink: 162 mm  
Minimum width  
of floor cupboard: 450 mm

### Dénorm 060.



STAINLESS STEEL DE060

Dimensions: 463 x 471 mm  
Depth of sink: 162 mm  
Minimum width  
of floor cupboard: 500 mm

### Dénorm 050.



STAINLESS STEEL DE050

Dimensions: 610 x 480 mm  
Depth of sink: 150 mm  
Minimum width  
of floor cupboard: 600 mm

These stainless steel sinks can be installed in worktops made of solid surface material HI-MACS<sup>®</sup>.

---

## Dénorm 042.

---



STAINLESS STEEL DE042

Dimensions: 790 x 480 mm  
Depth of sink: 162 mm  
Minimum width  
of floor cupboard: 500 mm

---

## Dénorm 008.

---



STAINLESS STEEL DE008

Dimensions: 790 x 480 mm  
Depth of sink: 162 mm  
Minimum width  
of floor cupboard: 800 mm

---

## Dénorm 044.

---



STAINLESS STEEL DE044

Dimensions: 790 x 480 mm  
Depth of sink: 162 mm  
Minimum width  
of floor cupboard: 800 mm